

Stationary rotor pump

BQ 06

for the use in pre-fab works

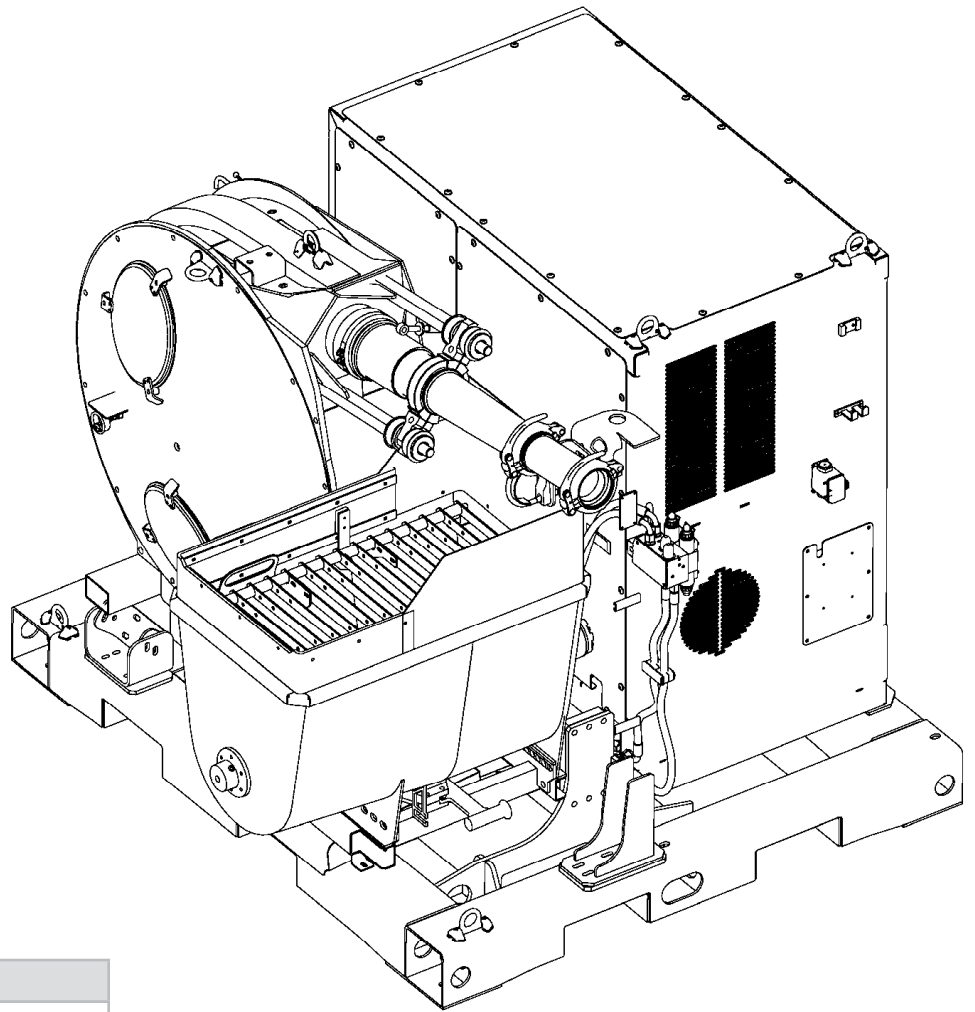

Technical data

Pump	R 65	
Output	m ³ /h	40
Delivery pressure	bar	25
Pumping hose	Ø mm	125
Hopper capacity	l	380

Power engine	HA 45 ci	
Drive electrical		400 V / 50 Hz
Fusage	A	123
Power	kW	45
Motor speed	1/min	1500
Hydraulic oil volume	l	100

Buffer storage - specific to the project		
Nominal capacity	m ³	2 – 7

Maximum outputs and maximum concrete pressures cannot be achieved simultaneously.
All data maximum theoretical.

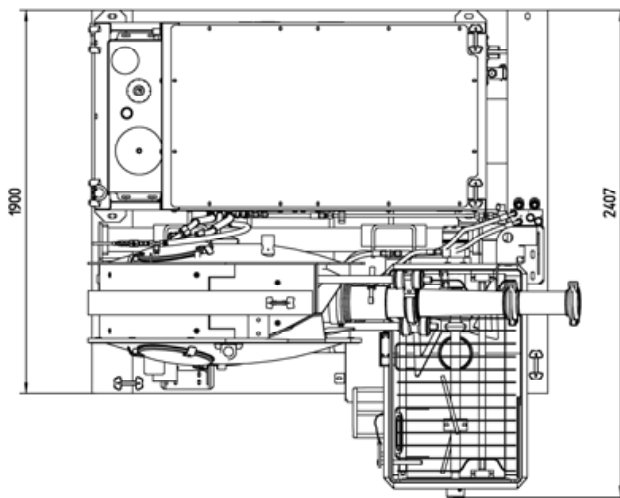
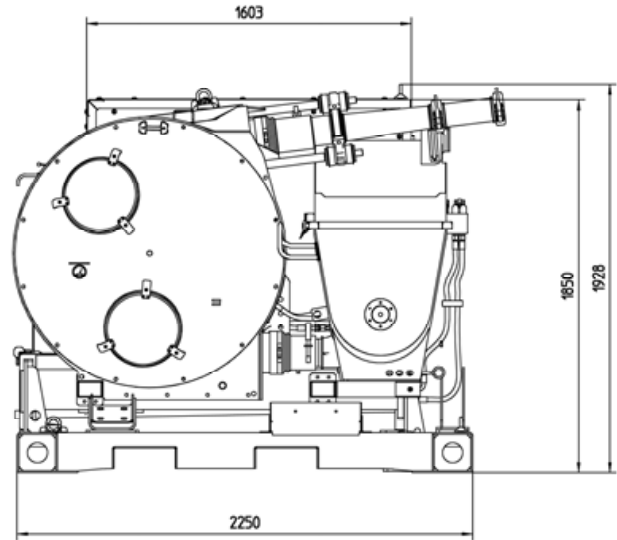
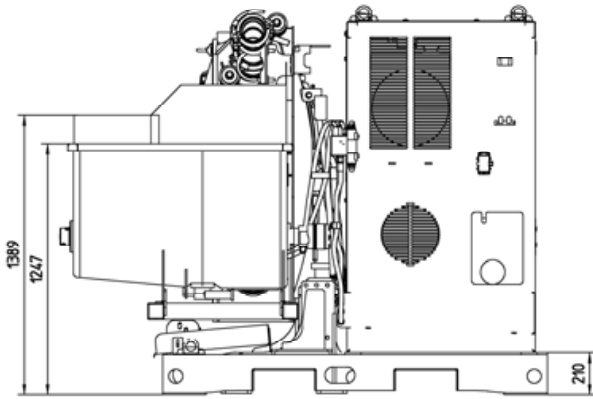

Total weight max. 3.8t, Standard version. Dimensions in mm.

Standard-Serienausstattung

Rotor pump Type R 65

Concrete hopper with agitator

Rubber collar

Agitator safety switch off

Operating manuals 1x cert. and spare part lists

Standard accessories

Central lubrication electrical

Painting MB 1227 chrome yellow

Remote control with 20m cable

Frame transportable by fork lift or crane

Cleaning accessories

Ergonic equipment

Output regulation, electrical

Delivery pressure regulation, electrical (EPS)

Operating data shown in Ergonic Graphic Display (EGD)

Sonderausstattung

Additional operator's manual + spare parts list 1x

Wheels for rails

Radio remote control

Buffer storage, specific to the project 2 – 7 m³

Extension feet

E-Motor 30 kW (Fusage 63 A)

Other optional extras on request.

See quotation for exact serial delivery scope.
Comprehensive range of options available on request.